

999

I 981

500R



8000
 A 69.50
 H 25.00
 4.00
 1.20

 99.70

Affidavit and Copy of the
 Record / Certificate from
 Annual Production to Court
 in proof of agricultural status
 With Membership Slip
 Court's Memo No. of 1988

1988-89 - अग्रिकारी प्रमाणपत्र

A 69.50
 H 25.00
 4.00
 1.20

 99.70

1988-89
 अग्रिकारी प्रमाणपत्र

10000 रु. का प्रमाणपत्र

प्रमाणपत्र -

1. अग्रिकारी प्रमाणपत्र को धरती का कानून अन्तर्गत
 अन्तर्गत प्रमाणपत्र 2. अग्रिकारी प्रमाणपत्र को धरती

Register

14876
 Smt. Sukrani Chowdhury
 Vill Desbandh Nagar
 Baguikati, Barasat



9/3 7
 300/-
 200/-
 7/-
 1/-
 708/-

1:20 b
 13th March 91
 Subinika Das, Barasat

শ্রী সুনীল কুমার বসু

Addl. District Registrar,
 Barasat, 24-Parg. (N)

137879

শ্রী সুনীল কুমার বসু

E. L. disposed with 12(1)(b)

A. D. R., Barasat.

137879

শ্রী সুনীল কুমার বসু

E

Subinika Das, Barasat
 S/o of Smt. Sukrani Chowdhury
 25/1 Kaulbargachi 2nd Lane
 Tulsiganj
 Calcutta
 13th March 91

L

Subinika Das, Barasat
 S/o of Smt. Sukrani Chowdhury
 25/1 Kaulbargachi 2nd Lane
 Tulsiganj
 Calcutta
 13th March 91

Addl. District Registrar,
 Barasat, 24-Parg. (N)

137879



2

Handwritten text in Devanagari script, oriented vertically on the right side of the page.

Handwritten text in Devanagari script, consisting of several lines of text.

Handwritten text in Devanagari script, appearing as a signature or date at the bottom of the page.

A small handwritten mark or symbol at the bottom center of the page.

14876
Smt. Indrani Choudhury
vill. Desbandha nagar
Barani lat. P. S. Barasat. Burdga.
[Signature]

12 500/-
12 200/-
12 71/-
12 11/-

708/-



Addl. District Registrar,
Barasat, 24, Panchayat

15/2/81
[Signature]

Handwritten text in the upper section, appearing to be a list or series of notes.

Handwritten text in the lower section, continuing the list or notes.

Handwritten text at the top right, possibly a title or date.

Handwritten text block in the upper middle section, consisting of several lines of cursive script.

Handwritten text block in the lower middle section, continuing the cursive script.

Handwritten text at the bottom of the page, possibly a signature or concluding remarks.

Handwritten text at the top right, possibly a page number or date.

Handwritten text in the upper middle section, appearing to be a list or set of instructions.

Handwritten text in the middle section, continuing the list or instructions.

Handwritten text in the lower middle section, possibly a continuation of the list.

Handwritten text at the bottom, possibly a signature or a specific instruction.

Handwritten text at the very bottom of the page.

Handwritten text on the right margin, possibly a name or title.

Handwritten text in the middle section, appearing to be a list or notes. The text is written in a cursive style and includes several lines of illegible script.

Handwritten notes on the bottom left, including a small diagram or list of items.

Handwritten notes on the bottom right, including a signature and some illegible text.

DE MO



Addl. District Registrar,
Baraset

18/12/81

১১.৬০
০-৫৫
১-১০
৬৯৬৯
১৮/১২/৮১



১৯
২৬৯
১২১
১১২১

২৪-৭-৮১

SITE PLAN OF C.S PLOT NO-687 (POR). U.S.H.K.
MOUZA-RAGHUNATHPUR. J.L NO-8. R.S NO-134.
P.S- RAJARHAT. DIST- 24 PARGANAS.
AREA SOLD:- 2 K-1 CH-2 S.F.T
SCALE: 1"= 20'-0" F.T.

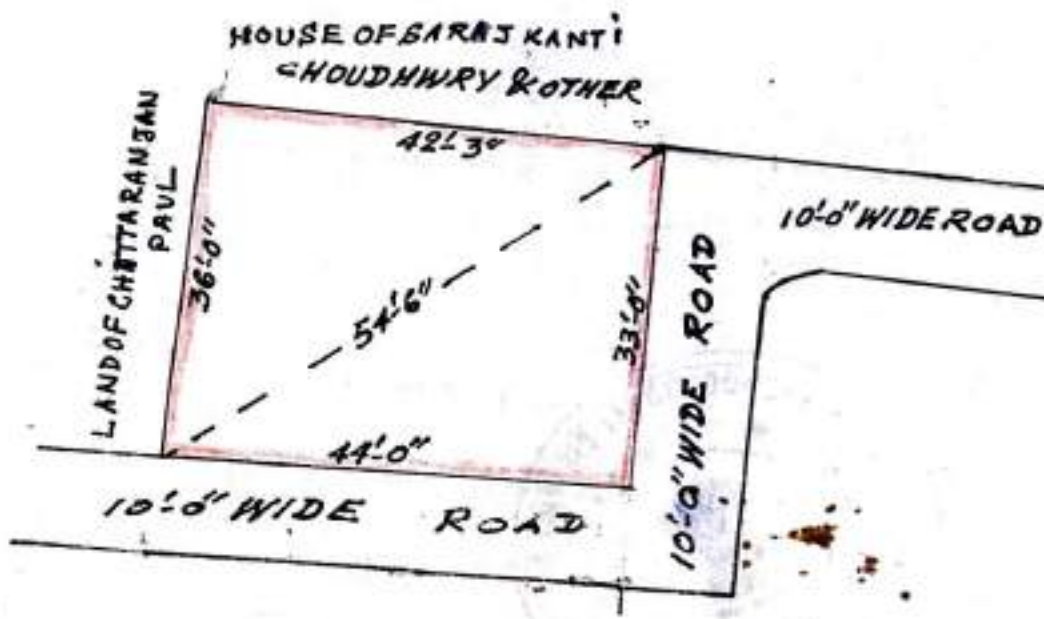
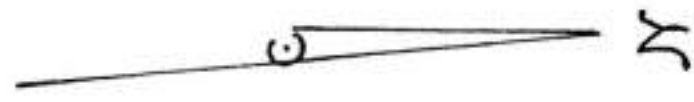

DRAWN BY:-
SRISAMIR GHOSH.
POST & VILL-JANGRA.
P.S- RAJARHAT.
DIST- 24 PARGANAS.
12-3-81

